

M2.06.01 rev.2 – 2nd January 2024.

Table of ingots dimensions and weights.

All weights and dimensions must be considered indicative.

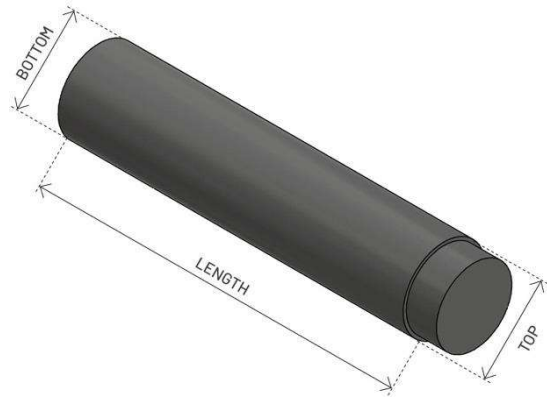

Round Ingots

INGOT	SIDES n°	INGOTS PER HEAT		DIMENSIONS				TOTAL WEIGHT [kg]		WEIGHT WITHOUT TOP [kg]		BOTTOM WEIGHT	
				TOP Ø [mm]	BOTTOM Ø [mm]	LENGTH [mm]						Standard	Premium
						min	max	min	max	[Kg]			
T310	-	11	12	300	310	4.130		2.550		2.400		N	
T380	-	7	8	370	380	4.350		3.900		3.780		N	
T420	-	6	8	420	420	4.310		4.770		4.600		N	
T480	-	5	6	480	480	4.280		6.250		5.970		N	
T540	-	4	5	540	540	4.320		7.900		7.600		N	
T600	-	3	4	610	620	3.910	4.330	9.330	10.300	8.960	9.930	N	
T680	-	3	4	670	670	3.890	4.300	11.150	12.250	10.600	11.700	N	
T800	-	2	4	800	810	2.960	4.460	12.500	18.450	11.420	17.370	N	
T900	-	2	3	890	890	2.580	3.970	13.570	20.300	12.210	18.940	N	
T1000	-	1	2	990	990	4.000	5.230	26.000	33.400	24.190	31.590	160	
T1000B	-	2		990	990	2.400		16.250		14.430		160	
T1200	-	1	2	1.200	1.200	2.640	4.640	26.800	44.200	23.600	41.000	500	1.000
T1300	24	1		1.280	1.280	2.840		31.000		27.750		500	1.000
T1450	-	1		1.450	1.450	2.020	3.880	32.200	55.850	26.200	49.850	500	1.000

The number of ingots is related to the total weight of the cast:

- Minimum melt weight = 26.600 kg
- Maximum AOD capacity = 40.000 kg

Different combinations of ingots or special requests of weight may be discussed with the Commercial Department.



ASONEXT
Steeled for the future

ASONEXT S.p.A. Società Benefit Unipersonale
Via Seriola 122 - 25035 Ospitaletto (BS) ITALY
P. +39030.6841011 - info@asonext.com
www.asonext.com